



SCHEDULE OF DOORS & WINDOWS			
NO	SILL	LINTEL	SIZE
DW	—	3000	2700X3000
D1	—	2350	1200X2350
D1A	—	2350	1000X2350
D2	—	2350	900X2350
D2A	250	2400	900X2400
D3	—	2350	750X2350
D4	250	2400	1200X2400
F.C.D	—	2350	1200X2350
F.C.D-1	—	2350	1125X2350
SD	—	2350	3000X2350
SD1	—	2350	2400X2350
SD2	—	2350	2100X2350
SD3	—	2350	1950X2350
SD4	—	2350	1800X2350
SD5	—	2350	1500X2350
W	350	2350	9000X2000
W1	350	2350	2400X2000
W1A	350	2350	2100X2000
W1B	350	2350	1800X2000
W1C	350	2350	1500X2000
W2	1050	2350	1200X1300
W3	350	2350	850X2000
W3A	350	2350	900X2000
W3B	350	2350	850X2000
W3C	900	2150	900X1250
W4	1250	2350	600X1100
W4A	350	2350	600X2000
SW	530	2350	1800X1820
SW1	655	2350	1800X1495
SW2	530	2350	1200X1820
SW3	655	2350	1200X1495
SW4	695	2350	1800X1655
SW5	530	2350	1800X1330
SW6	695	2350	900X1655
SW7	530	2350	1200X1330

- #1 MECHANICAL VENTILATION & ARTIFICIAL LIGHTING
- #2 PRESSURIZED LIFT SHAFT
- #3 STORES FOR NON COMBUSTIBLE HOUSEHOLD ARTICLES

SPRINGCITY BUILDCON LLP
 PAKS TRADE CENTRE LLP
 HARMONY MERCHANTS LLP
 VARDHAMAN GEARS LLP
Pana Mall
 Authorised Signatory
 SIGNATURE OF OWNER

CERTIFICATE OF STRUCTURAL ENGINEER.
 THIS IS TO CERTIFY THAT THE STRUCTURAL DESIGN AND DRAWING OF BOTH FOUNDATION AND SUPER STRUCTURE OF THE BUILDING HAS BEEN MADE BY ME CONSIDERING ALL POSSIBLE LOADS INCLUDING THE SEISMIC LOAD AS PER THE NATIONAL BUILDING CODE OF INDIA AND CERTIFIED THAT IT IS SAFE AND STABLE IN ALL RESPECTS.
 SANJIV J. PANKH
 M.E.(STRUCT.), M.E.(CONST. ENG.),
 B.C.E., F.I.E-(F)18202-4
 E. S. E. No. 104 (I) K.M.C.
 SIGNATURE OF STRUCTURAL ENGG.

SANJIB GUHA
 BSC, BCE, F.I.E-(F-115654-5)
 CHARTERED ENGINEER
 ENLISTED STRUCTURAL
 REVIEWER 68/16 K.M.C.
 SIGNATURE OF STRUCTURAL REVIEWER.

JISHNU PAL
 B.Tech (Civil), M.E. (Gen. Tech)
 KMC Reg No: G-T/1/32
 G.T.E.R./NKDA/10/0043
 22/RJISON/G-T/1/2016-17
 SIGNATURE OF GEO-TECHICAL ENGG.

CERTIFICATE OF ARCHITECT
 I DO HEREBY CERTIFY WITH FULL RESPONSIBILITY THAT THE BUILDING PLAN HAS BEEN DRAWN UP AS PER K.M.C. BUILDING RULES - 2008 AS AMENDED FROM TIME TO TIME. THE WIDTH OF THE ABUTTING ROAD CONFORM WITH THE PLAN AND IT IS A BUILDABLE SITE TANK. THE SITE PLAN, LOCATION PLAN AGREES WITH THE SITE. THE PLOT IS DEMARCATED BY BOUNDARY WALLS & MEASUREMENTS TALLY WITH THE RECD. DEED PLAN. THE EXISTING STRUCTURE AS SHOWN FULLY OCCUPIED BY OWNERS AS PER OWNERS UNDERTAKING.
 JAY PRAKASH BHARAT KUMAR AGRAWAL
 B. Arch., A.I.I.A.
 Reg. No. CA / 86 / 0098
 ARCHITECT (S.I. NO. - 324A)
 SIGNATURE OF ARCHITECT

TITLE - TYPICAL FLOOR PLAN (4TH, 7TH, 10TH, 13TH, 16TH, 19TH. FLOOR) & ROOF PLAN & PART PLAN L.M.R. PLAN BLOCK-C
 PROJECT - PLAN SHOWING ADDITION & ALTERATION U/S 394 OF KMC ACT 1980 READ WITH U/R 26 (2a) & 26 (2b) OF KMC BUILDING RULE - 2008 AT RESIDENTIAL COMPLEX WITH BLOCK-A (G+XXXIV), BLOCK-B (L-G+IV+VI), BLOCK-C (G+XIX) & BLOCK-D (G+II) STORED AT 33A, CANAL SOUTH ROAD, KOLKATA-15, WARD NO.-57, BOROUGH-VI, SANCTIONED VIDE B.P NO-2016070060. DATED 04.08.16.
 ARCHITECTS - AGRAWAL & AGRAWAL
 BARODA KOLKATA
 SCALE - 1:100 DATE 09.08.2021 DEALT SAMPA CHECKED SHILA
 SHEET NO. -15/23

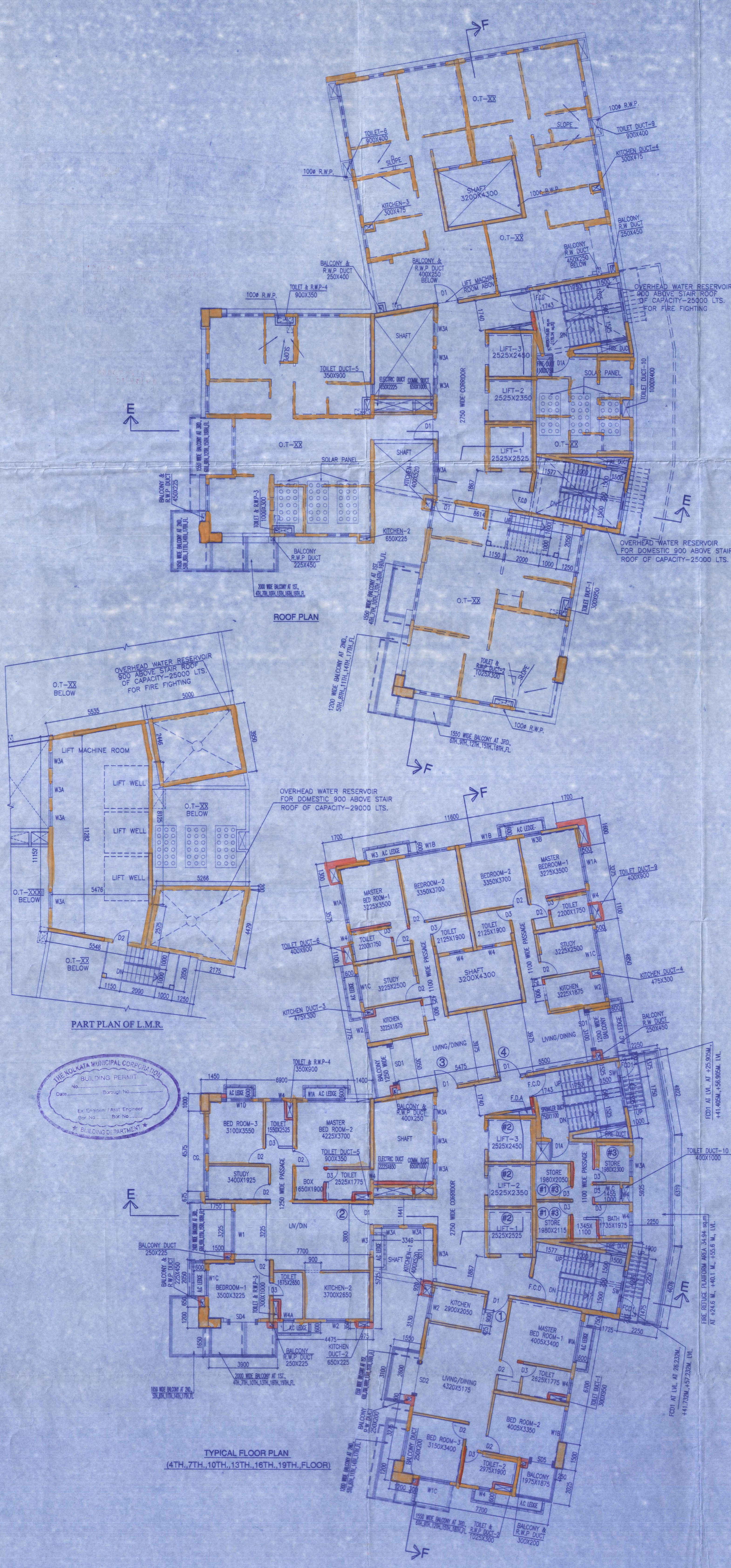

PARTY'S COPY

Plan for Water Supply arrangement including S.F.M.I. G. & O. H. reservoirs should be submitted at the Office of the Ex-Engineer Water Supply and the sanction obtained before proceeding with the work of Water Supply any deviation may lead to disconnection/demolition.

Before starting any Construction the site must conform with the plans sanctioned and all the conditions as proposed in the plan should be fulfilled.
The validity of the written permission to execute the work is subject to the above conditions.

No rain water pipe should be fixed or discharged on Road or Footpath. Drainage plan should be submitted at the Borough Executive Engineer's Office and the sanction obtained before proceeding with the drainage work.

Design of all Structural Members including that of the foundations should conform to Standards specified in the National Building Code of India.

A suitable pump has to be provided i.e. pumping unfiltered water for the distribution to the flushing cisterns and urinals in the building in case unfiltered water from street main is not available.

All Building Materials to necessary & construction should conform to standards specified in the National Building Code of India.

DEVIATION SHOULD MEAN DEMOLITION

Non Commencement of Erection/ Re-Erection within Five year will Require Fresh Application for Sanction

THE SANCTION IS VALID UP TO.....

CONSTRUCTION SITE SHALL BE MAINTAINED FREE FROM AIR POLLUTION ACCORDING TO UNDERTAKING SUBMITTED AS PER AMENDMENT DT. 31.01.2019 VIDE NO. 259/A/O/C-4/BR.72017 OF SCHEDULE-IV OF KMC BUILDING RULE 2009

Approved By
The Building Committee

CONSTRUCTION SITE SHALL BE MAINTAINED TO PREVENT MOSQUITO BREEDING AS REQUIRED U/S 496 (1) & (2) OF CMC ACT 1980. IN SUCH MANNER SO THAT ALL WATER COLLECTION & PARTICULARLY PIT WELLS, VATS, BASEMENT CURING SITES, OPEN RECEPTACLES ETC. MUST BE EMPTIED COMPLETELY TWICE A WEEK.

The building materials that will be stacked on Road/Passage or Footpath beyond 3-months or after completion of G. Floor, whichever is earlier may be seized forthwith by the K.M.C. at the cost and risk of the owner.



Provisionary steps should be taken for the safety of the lives of the adjoining public and private properties during construction.

The sanction refers to the proposed portion shown in red and the Executive Engineers makes no admission as to the correctness of the plan.

APPROVED

ASSISTANT ENGINEER (C)
BOROUGH NO.

* Provison for use of solar energy in the form of solar heater and / or solar photo-cells shall be provided as required under Rule 147 of Building rules, 2009 and completion certificate will not be issued in case of building without having such provision *

Approved subject to Compliance of requirement of West Bengal Fire Services, if any.

RESIDENTIAL BUILDING

OFFICE OF THE EXECUTIVE ENGINEER
BUILDING BOROUGH-VII
DATE: 11/2/22
THE KOLKATA MUNICIPAL CORPORATION

KOLKATA MUNICIPAL CORPORATION
BUILDING DEPTT.
PLANS APPROVED U/R 26 (2a) & (2b) of
K.M.C. BUILDING RULES 2009
By D.G.(Bldg)-Dy. C.E.(S/N)-Ex. Engr. M. BC meeting no. 580
ON 31.03.22. SANCTION NO. 184/22
B.S. Plan No. 201.60.700.60
B.P. No. 201.60.700.60 DL 04/18/16 BR. No. 111
Assistant Engineer Ex. Engr. (C/B)
Bor. No. 111 Bldg. Br. VII
K.M.C.

This Plan is To Be Treated As Part
And Parcel And Continues To
B. S. Plan No. 201.60.700.60
Dated: 04/08/16
Ex. Engr. (C-B)
Bor. No. 111
Bldg. Br. VII
K.M.C.